

警告

本说明页中所述全部操作都必须且只能由专业人员完成。安装装置时,请关掉所有电压设备以及遵守有关国家安装操作规定。最终用户与/或安装人员需对以下负责,保证:保证系统的电,机械与温度与所安装的框架以及相连接的设备的兼容性。安装轨道时,不可超过文件中所规定的荷载和距离轨道与其配件以及适配器,不可与不带质量标志的部件一起用。A.A.G. Stucchi的轨道只可以使用的连接件, A.A.G. Stucchi的连接件只能用于A.A.G. Stucchi的轨道。A.A.G. Stucchi公司允许只能使用A.A.G. Stucchi的零配件用于MULTISYSTEM®/MULTISYSTEM® EVO轨道系统。零配件需要正确地按照安装说明来进行安装。如果使用非原厂的零配件,或者没有符合安装说明,那么作为生产厂家将不对系统的安全性和功能性所负责。这种情况下使用者有责任确保产品和灯具间的电气性,机械性及热容性的相兼容。该跟踪系统是 III 级标准系统,和其他制造商的 I 级或 III 级跟踪系统并不兼容。为避免电路短路和过载,请插入合适的电源电路保护装置。

产品和安装的安全警告

- 严禁使用NON SELV或U-OUT > 60V直流电源,驱动器和组件。

A.A.G. Stucchi建议使用兼容光电隔离的中继器(例如RP-DALI-24-48V)。

- 您可以选择在2种不同模式下使用轨道的4根导线:
 - 2种不同的电源(2个电路, 0 - 60V dc)
 - 1个用于60V dc的电路和1个用于数据总线的电路

如果您想在您的照明项目(建筑,商店等)中创建一个独特的数据总线,将低压轨道数据总线与其他照明应用的数据总线电气连接,所有相关组件必须经过SELV批准。

严禁使用与MULTISYSTEM®/MULTISYSTEM® EVO组件接触的任何溶剂,胶水,油,油脂或清洁剂。对于因使用上述材料而造成的任何损害,本公司概不负责。

WARNING

All the operations must be done by specialized personnel only, shutting of the electrical power and respecting all national installation regulations and guidelines. A.A.G. Stucchi allows the use of only A.A.G. Stucchi parts in applications where the MULTISYSTEM®/ MULTISYSTEM® EVO system is installed. These parts must be installed according to the installation instructions. The company as a manufacturer is not responsible for the safety and functioning of the MULTISYSTEM®/ MULTISYSTEM® EVO system if components not belonging to it are used or if there are any deviations from the installation instructions. It is then the third-party manufacturer's responsibility to ensure the correct functionality and the electrical, electromechanical, electronic, mechanical and thermal compatibility between the MULTISYSTEM®/ MULTISYSTEM® EVO system and any other third-party products that are used or even developed for the system itself (i.e. drivers/fixtures). The track, its components and also the adapters can't be used with accessories without the Quality/ Approval Mark of the region. On A.A.G. Stucchi track one can use only A.A.G. Stucchi connections. A.A.G. Stucchi connections can be used only with A.A.G. Stucchi tracks. This track system is Class III and is not compatible with Class I track systems or Class III track systems from other manufacturers. Insert the appropriate power circuit protections in order to prevent short circuits or overloads.

Safety warnings for products and installation

- The use of NON SELV or U-OUT > 60V dc power supplies, drivers and components is strictly forbidden.

A.A.G. Stucchi recommends the usage of an opto-insulated repeater dali compatible (es. RP-DALI-24-48V).

- You can choose to use the 4 conductors of the track in 2 different modes:
 - 2 different power supplies (2 circuits, 0 - 60V dc)
 - 1 circuit for 60V dc and 1 circuit for Data Bus

If you want to create a unique Data Bus in your lighting project (building, shop, etc.), electrically connecting the low voltage track Data Bus with the Data Bus of other lighting applications, all the components involved must be SELV approved.

It is strictly forbidden to use any kind of solvent, glue, oil, grease or cleaner in contact with MULTISYSTEM® components. The company is not responsible of any damage caused by the use of the materials mentioned above.



电源接头

ADAPTER

Versione magnetica
Magnetic version

Versione meccanica
Mechanical version

Versione non polarizzata
Non polarized version

Versione polarizzata
Polarized version

Installazione corretta
Correct installation

Installazione errata
Incorrect installation

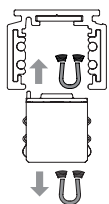

Fig. 1a
Pic. 1a

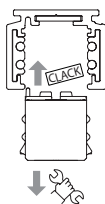

Fig. 1b
Pic. 1b

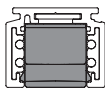

Fig. 2
Pic. 2

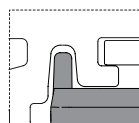

Fig. 3
Pic. 3

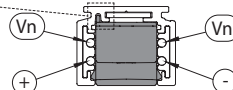

Fig. 4
Pic. 4

MULTISYSTEM®适配器有两个版本：

- 磁性版本：适配器配有永磁体，可将其磁化到导轨内的金属板上（图1a）。
- 机械版：安全自动插入块中（图1b）。

MULTISYSTEM® adapters are available in two versions:

- magnetic version: adapters are equipped with permanent magnets which provide a connection to the metal plate inside the track (Pic. 1).
- mechanical version: adapters with automatic mechanical lock (Pic. 1b).

所有MULTISYSTEM®适配器系列有两个版本：非极化（无机机械键，代码9519...和9529...图2）和极化（带机械键，代码9519...-K...和9529...-K...图3）。使用极化适配器时，将适配器插入轨道时要特别小心。一旦插入钥匙正确定位，适配器必须与轨道完美配合而不会突出，并且钥匙不得干扰轨道（图4）。

All MULTISYSTEM® adapters series come in two versions: nonpolarised (without mechanical key, codes 9519... and 9529... Pic. 2) and polarised (with mechanical key, codes 9519...-K... and 9529...-K... Pic. 3). When using polarised adapters, take special care when inserting the adaptor into the track. Once inserted with the key properly oriented, the adaptor must fit perfectly flush with the track without protruding, and the key must not interfere with the track (Pic. 4).

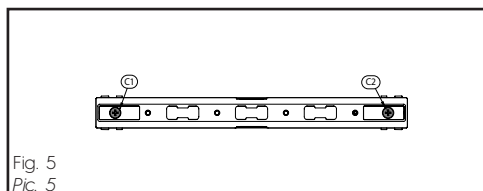

Fig. 5
Pic. 5

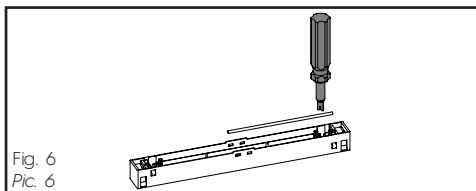

Fig. 6
Pic. 6

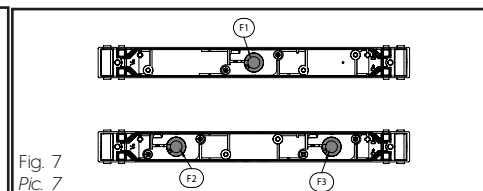

Fig. 7
Pic. 7

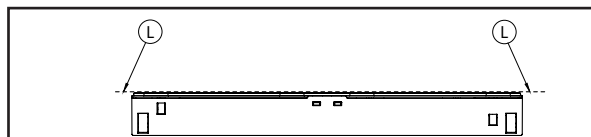

Fig. 8
Pic. 8

在为适配器接线时，请根据灯具的电流值，使用横截面为0.5mm²至1mm²的扭绞和镀锡电缆。拧下C1-C2两只螺钉（图5），拆下适配器的罩盖。使用专用工具（由S-9009/T-HAN+S-9009/T-INS组成，需单独订购）为适配器接线（图6），并遵守适配器内部标注的正确极性（Vn, +, -）；然后推动电缆，直到其完全插入接线端子的接点中。4个接点的接线完成后，将电缆穿过中心孔F1（如果使用代码为9519...的配件）或两个侧孔F2和F3（如果使用代码为9529...的系列配件）（图7）。在将照明灯具安装到适配器上时，可以使用配备的附件：S-9519/5 + S-9519/M8或S-9519/M10。完成接线并将照明灯具固定到适配器上之后，将罩盖放在适配器上，并拧上C1和C2两只螺钉（如果使用极化版本，请注意罩盖的安装方向）。

To wire the adapter, use stranded and tinned cables with cross sectional area between 0.5 mm² and 1 mm² rated appropriately for the luminaire's power to be connected to the adapter. Remove the adapter cover by loosening the two screws C1-C2 (Pic. 5). Wire the cables to the adapter (Pic. 6) using the appropriate tool (made up of S-9009/T-HAN+S-9009/T-INS, to be ordered separately) and comply with the pole markings inside the adapter (Vn, +, -); push the cable in until it is completely inserted in the IDC contact. After wiring the 4 contacts, feed the cables through the central hole F1 (if items 9519... are used) or through the two side holes F2 and F3 (if series 9529... items are used) (Pic. 7). The luminaire can be fastened to the adapter using the following accessories: S-9519/5 + S-9519/M8 or S-9519/M10. After wiring the fitting and fastening it to the adapter, put the cover on the adapter and tighten the two screws C1 and C2 (when using polarised versions, make sure that the cover is mounted in the proper direction).



在安装完成之后，适配器的罩盖必须与 L 平面保持完美齐平，没有任何凸出，以免适配器被安装在轨道中时妨碍适配器本身的准确活动（图 8）。

Once mounted, the adaptor cover must be perfectly level with the plane L, without bulging, so that it does not interfere with the correct operation of the adaptor once it is installed on the track (Pic. 8).

旋转套件以及 M8 或 M10 连接件

ROTATION KIT AND M10 OR M8 NIPPLES

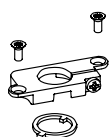

Fig. 9
Pic. 9

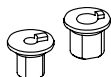

Fig. 10
Pic. 10

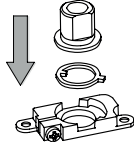

Fig. 11
Pic. 11

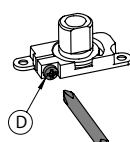

Fig. 12
Pic. 12

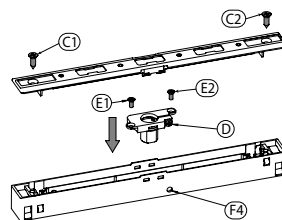

Fig. 13
Pic. 13

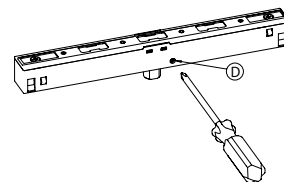

Fig. 14
Pic. 14

在将照明灯具安装到适配器上时，可以使用配备的附件：S-9519/5 (图 9) + S-9519/M8 或 S-9519/M10 (图 10)。如果使用 9529... 系列适配器，还需要订购两个旋转套件和两个连接件。首先将特制垫圈放置在旋转套件的塑料体内，然后再安装 S-9519 / M10 或 S-9519 / M8 连接件 (图 11)。接着，轻轻拧上螺钉 D，以便将垫圈和连接件固定在塑料座内部 (图 12)。从 9519... 或 9529... 系列适配器上拧下 C1-C2 两只螺钉，然后取下罩盖；接下来插入先前已经用垫圈和螺纹连接件组装的旋转套件，使其穿过适配器本身底座上的孔。在组装过程中，旋转套件的螺钉 D 必须位于适配器侧面 F4 孔的同侧。接下来，使用 E1-E2 两只螺钉将旋转套件拧紧在适配器上。完成操作之后，将罩盖放在适配器上，并拧上 C1 和 C2 两只螺钉 (图 13) (如果使用极化版本，请注意罩盖的安装方向)。为了增加或减少灯具在适配器上的摩擦，可以使用合适的螺丝刀拧紧或拧松螺钉 D (图 14)。

The luminaire can be fastened to the adapter using following accessories: S-9519/5 (Fig. 9) + S-9519/M8 or S-9519/M10 (Fig. 10). If series 9529... adapters are used, two rotation kits and two nipple kits must be ordered. First place the special washer inside the plastic body of the rotation kit, followed by the S-9519/M10 or S-9519/M8 nipple (Fig. 11). Next, tighten screw D lightly so that the washer and nipple are held in place inside their plastic housing (Fig. 12). Loosen the two screws C1-C2 from the series 9519... or 9529... adapter and remove the cover; insert the rotation kit, previously assembled with the washer and threaded nipple, by passing it through the hole on the base of the adapter body. During assembly, screw D of the rotation kit must be on the same side as hole F4 on the side wall of the adapter. Subsequently, screw the rotation kit onto the adapter using the two screws E1-E2. After completing this operation, put the cover on the adapter and tighten the two screws C1-C2 (Fig. 13) (when using polarised versions, make sure that the cover is mounted in the proper direction). To increase or decrease the friction of the adapter against the stem of the luminaire, tighten or loosen screw D using an appropriate screwdriver (Fig. 14).



适配器插入 / ADAPTER INSERTION

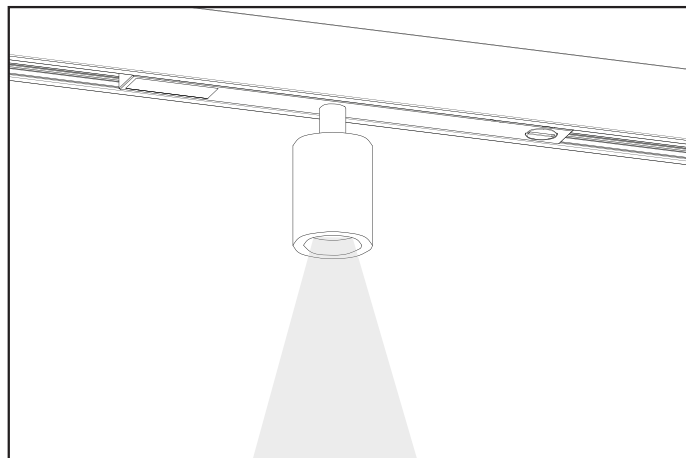
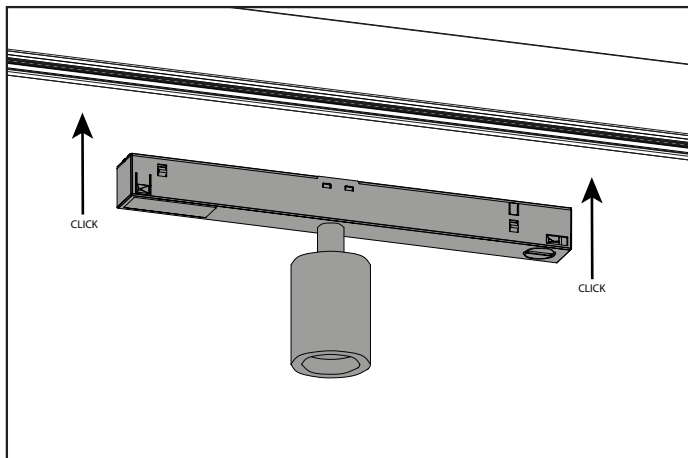

适配器拆卸 / ADAPTER REMOVAL

