

AC408F/SQ

PORTALAMPADE PER LAMPADE A SCARICA AI VAPORI D'ALOGENURI LAMPHOLDER FOR HALIDE VAPOUR DISCHARGE LAMPS

Dati tecnici

Technical data

- Attacco lampada - Lamp Cap	E40
- Corrente e tensione nominale - Rated current and voltage	16A-500V
- Temperatura massima di funzionamento (IEC) - Maximum operating temperature (IEC)	T300

Caratteristiche

Characteristics

con freno lampada

with lamp locking device





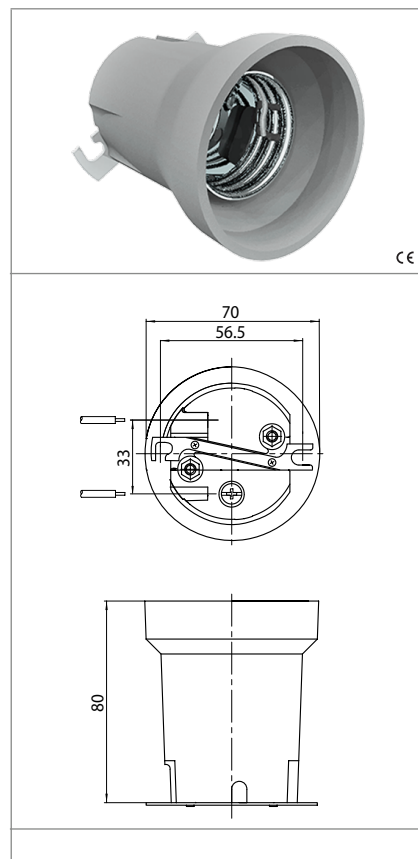

– Corpo in ceramica

– Ceramic body

– Virola in rame nichelato

– Nickel plated copper screwed shell

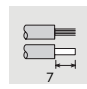

 fissaggio con vite screw fixing	 serrafilo con vite e dado terminals with screw and nut	 sezione conduttore flessibile flexible conductor section	 sezione conduttori rigidi rigid conductor section
 spelatura cavetti rigidi e flessibili rigid and flexible wires stripping	 adatto per tensione di accensione ad impulsi fino a... suitable for impulse ignition voltage up to...		

Marchi di qualità

Quality marks

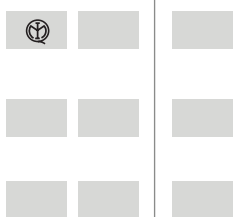

Direttive Europee

European directives

Conforme "RoHS"
"RoHS" compliant
Non soggetto alla "RAEE"
Not subject to "WEEE"

Pesi e confezioni

Weights and packaging

Art. Codice prodotti Product references	g Peso netto Net weight	n° pz per sacco per bag	n° pz per scatola per box	n° pz per cartone per carton
AC408F/SQ				

Note

Notes