

S-9001/H-C3-B-93

S-9001/H-C3-W-93

TAPPO PER TESTATA
END CAP FOR END-FEED

Dati tecnici
Technical data

| | |
|--|--|
| | |
| | |
| | |
| | |
| | |
| | |

Caratteristiche
Characteristics

- Corpo in policarbonato. Colori disponibili: nero RAL9005 (B) e bianco RAL9010 (W)
- Polycarbonate body. Available colours: black RAL9005 (B) and white RAL9010 (W)

| |
|--|
| |
| |
| |
| |
| |
| |

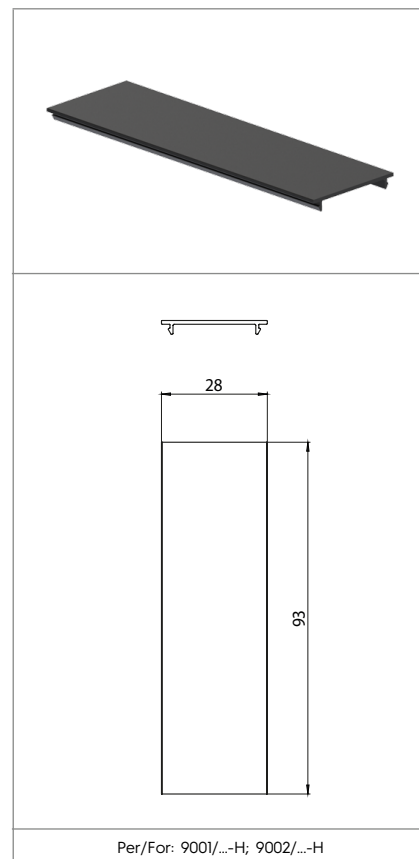

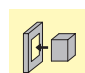
 fissaggio ad innesto
snap-in fixing

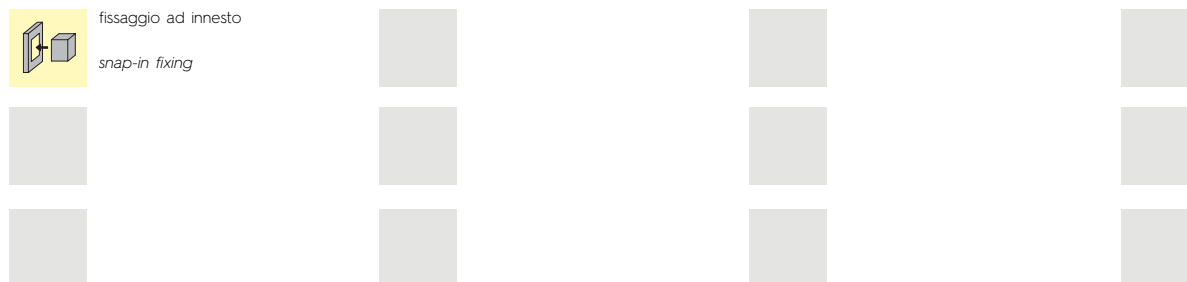

Marchi di qualità
Quality marks

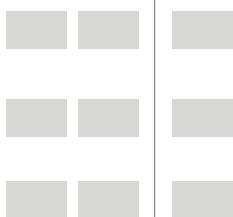

Direttive Europee
European directives

Conforme "RoHS"
"RoHS" compliant
Non soggetto alla "RAEE"
Not subject to "WEEE"

Pesi e confezioni
Weights and packaging

| Art. Codice prodotti <i>Product references</i> | g Peso netto <i>Net weight</i> | n° pz per sacco <i>per bag</i> | n° pz per scatola <i>per box</i> | n° pz per cartone <i>per carton</i> |
|--|--------------------------------------|--------------------------------------|--|---|
| S-9001/H-C3-B-93 | | | | |
| S-9001/H-C3-W-93 | | | | |
| | | | | |
| | | | | |
| | | | | |
| | | | | |
| | | | | |

Note

Notes