

1263/U0

1263/U90

**PORTALAMPADE CONNETTORE PER LAMPADE FLUORESCENTI LINEARI T5
PUSH-ON LAMPHOLDER FOR T5 FLUORESCENT LINEAR LAMPS**

Dati tecnici

Technical data





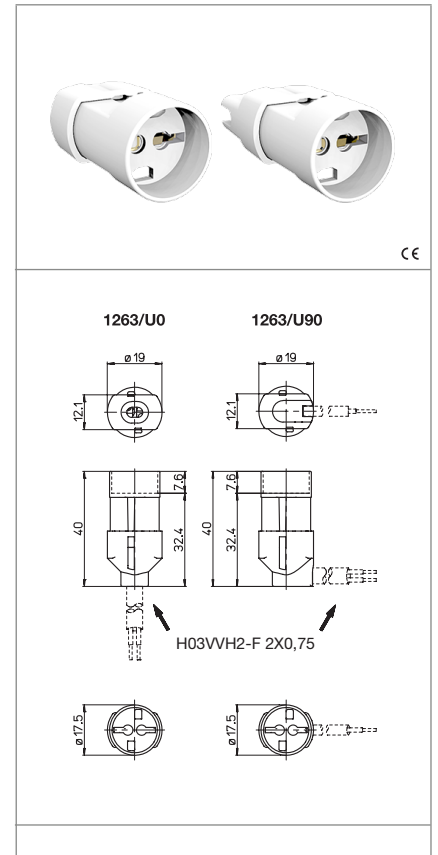

- Attacco lampada - Lamp Cap	G5
- Corrente e tensione nominale - Rated current and voltage	2A-500V
- Temperatura massima di funzionamento (IEC) - Maximum operating temperature (IEC)	T140
- Grado di protezione - Protection index	IP20
- Categoria di sovratensione - Impulse withstand category	III

Caratteristiche

Characteristics

- Corpo in PBT bianco
- White PBT body
- Contatti in lega di rame
- Copper alloy contacts
- Con cuffia smontata
- With dismantled cover

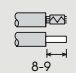

 fissaggio diretto sulla lampada push fixing on the lamp	 spessore thickness 32,4	 serrafilo automatico a 2 fori push-wire terminals with 2 holes	 diametro conduttore flessibile con fascetta diameter of the flexible conductor with ferrule ø1,8 max
 sezione conduttori rigidi rigid conductor section 0,5-1	 spelatura cavetti rigidi e flessibili con fascetta rigid and flexible with ferrule wires stripping 8-9	 36 136	

Marchi di qualità

Quality marks

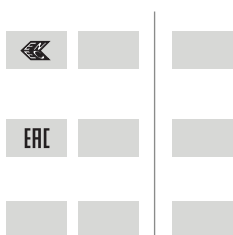

Direttive Europee

European directives

Conforme "RoHS"
"RoHS" compliant
Non soggetto alla "RAEE"
Not subject to "WEEE"

Pesi e confezioni

Weights and packaging

Art. Codice prodotti Product references	g Peso netto Net weight	n° pz per sacco per bag	n° pz per scatola per box	n° pz per cartone per carton
1263/U0	5		500	
1263/U90	5,3		500	

Note L'apparecchio di illuminazione deve essere sottoposto a tutte le prove relative alla sicurezza contro il contatto accidentale durante il cambio della lampada previste dalle norme EN/IEC 60598.

Notes All luminaires must undergo to all safety tests to protect against electric shock during the lamp replacement operation as prescribed by the EN/IEC 60598 standards.