

3142/FAU-TR

3142/MAU-TR

3142/C-FAU-TR

**PORTALAMPADE CONNETTORE PER LAMPADE FLUORESCENTI LINEARI T8
PUSH-ON LAMPHOLDER FOR T8 FLUORESCENT LINEAR LAMPS**

Dati tecnici

Technical data





- Attacco lampada - Lamp Cap	G13
- Corrente e tensione nominale - Rated current and voltage	2A-500V; 2A-250V(.../C-...)
- Temperatura massima di funzionamento (IEC) - Maximum operating temperature (IEC)	T110
- Grado di protezione - Protection index	IP20
- Categoria di sovratensione - Impulse withstand category	II

Caratteristiche

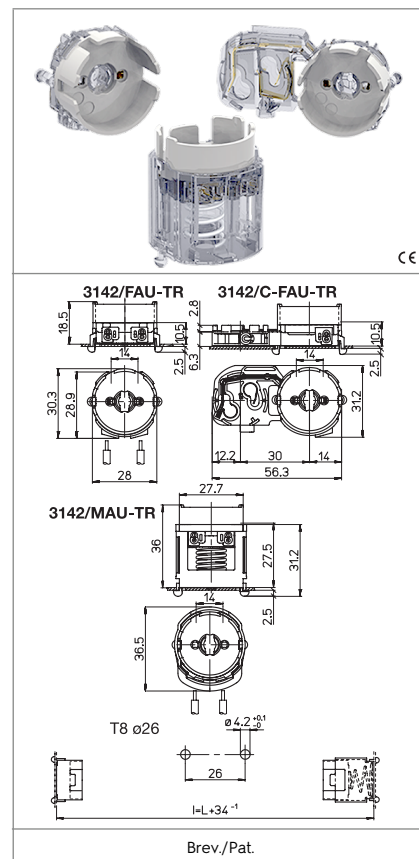
Characteristics

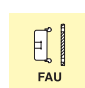
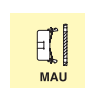
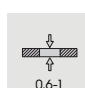
- Corpo in policarbonato trasparente e bianco
- Transparent and white polycarbonate body
- Contatti in lega di rame
- Copper alloy contacts
- Con top test
- With top test

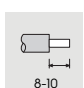

 fissaggio ad innesto posteriore, fisso <i>back mounting, fixed</i>	 fissaggio ad innesto posteriore, mobile <i>back mounting, adjustable</i>	 spessore lamiera di fissaggio <i>fixing metal plate thickness</i>	 spessore <i>thickness</i>
 spessore <i>thickness</i>	 serrafilo automatico a 2 fori <i>push-wire terminals with 2 holes</i>	 sezione conduttori rigidi <i>rigid conductor section</i>	 spelatura cavetti rigidi <i>rigid wires stripping</i>

Marchi di qualità

Quality marks

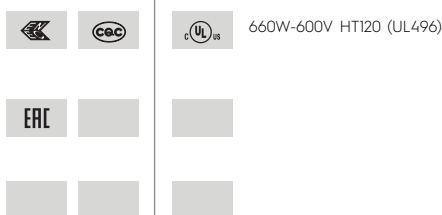

Direttive Europee

European directives

Conforme "RoHS"
"RoHS" compliant
Non soggetto alla "RAEE"
Not subject to "WEEE"

Pesi e confezioni

Weights and packaging

Art. Codice prodotti Product references	g Peso netto Net weight	n° pz per sacco per bag	n° pz per scatola per box	n° pz per cartone per carton
3142/FAU-TR	5,1	1000		
3142/MAU-TR	11,9	500		
3142/C-FAU-TR	7,7	500		

Note L'apparecchio di illuminazione deve essere sottoposto a tutte le prove relative alla sicurezza contro il contatto accidentale durante il cambio della lampada previste dalle norme EN/IEC 60598.

Notes All luminaires must undergo to all safety tests to protect against electric shock during the lamp replacement operation as prescribed by the EN/IEC 60598 standards.